

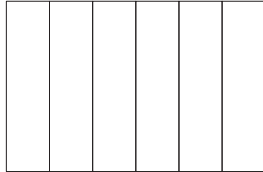

# ROSEMONT FASCIA WALL COLLECTION

**DESCRIPTION:** Fascia Panel & Corner **TEXTURE:** Klean-Bloc Slate

## PALLET OVERVIEW - PANELS



## PALLET OVERVIEW - CORNERS

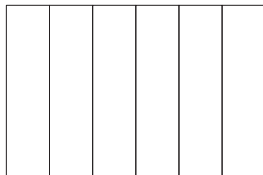

Specifications per pallet		Imperial	Metric
FASCIA	Cubing	<b>42 units</b>	42 units
		44.75 ft <sup>2</sup>	4.16 m <sup>2</sup>
		90.94 lin. ft	27.72 lin. m
	Approx. Weight	1 240 lbs	562 kg
	Number of rows	7	
	Coverage per row	6.39 ft <sup>2</sup>	0.60 m <sup>2</sup>
	Linear coverage per row	13.03 lin. ft	3.96 lin. m

Unit dimensions		in	mm	Units/pallet
A	Height	5 7/8	150	42 units
	Depth	2 3/4	70	
	Length	26	660	



## COMPATIBLE CAPS

See page 137 for product compatibility.

**Klean-Bloc technology**  
See page 20.

## NOTES

See page 138 to 153 for more technical information.

Fascia Panels require single-sided structural blocks (retaining wall application) or double-sided structural blocks (freestanding walls). Sold Separately.

Specifications per pallet		Imperial	Metric
CORNER	Cubing	<b>24 units</b>	24 units
	Approx. Weight	660 lbs	299 kg
	Number of rows	4	
	Pillar height	35 7/16 in	900 mm

Unit dimensions		in	mm	Units/pallet
A LEFT UNIT	Height	5 7/8	150	12 units
	Depth	2 3/4	70	
	Length	23 1/4	590	

Unit dimensions		in	mm	Units/pallet
B RIGHT UNIT	Height	5 7/8	150	12 units
	Depth	2 3/4	70	
	Length	23 1/4	590	

The top of Fascia Panels shall not be left exposed, they must be stabilized with a structural block on top or glued to the cap.

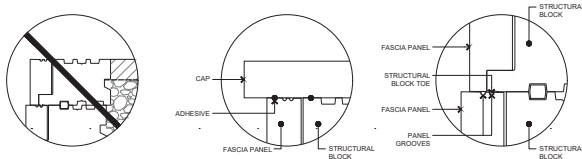

Chocolate Brown

Rock Garden Brown

Riviera

Azzurro

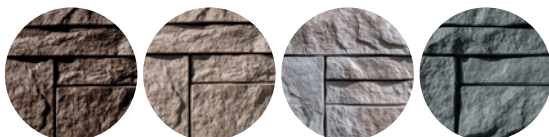

# INSTALLATION GUIDE

## FREESTANDING WALL

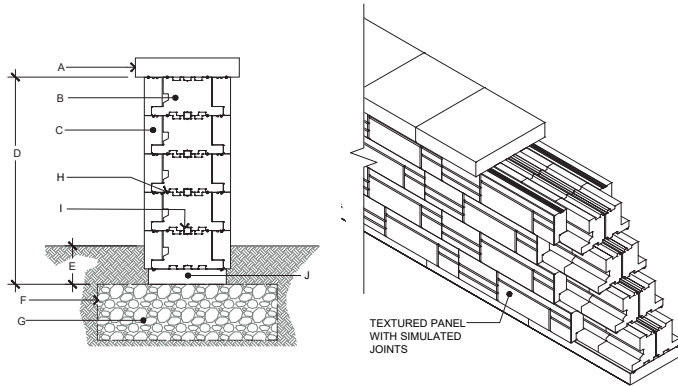

- A. TECHO-BLOC CAP UNIT SECURED TO CORE AND PANEL BELOW WITH FLEXLOCK ADHESIVE
- B. STRUCTURAL BLOCK DOUBLE-SIDED UNIT
- C. PANEL UNIT
- D. 29 1/2" (750 mm) MAX.
- E. EMBEDMENT DEPTH 6" (150 mm) MIN.
- F. GEOTEXTILE
- G. COMPACTED GRANULAR BASE 6" (150 mm) MIN. THICKNESS ACCORDING TO PROJECT SPECIFICATIONS
- H. FLEXLOCK ADHESIVE
- I. HDPE HORIZONTAL KEY
- J. BASE UNIT

## FREESTANDING WALL - 90° CORNER

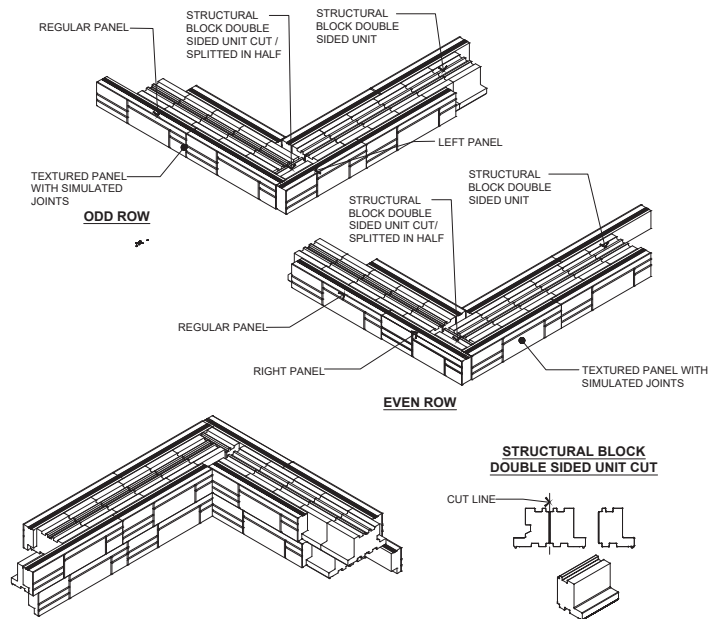

1. ALTERNATE ODD AND EVEN ROWS.
2. STAGGER STRUCTURAL BLOCKS JOINTS FROM ONE ROW TO THE NEXT.
3. GLUE ALL STRUCTURAL BLOCKS AT EACH ROW WITH FLEXLOCK ADHESIVE.
4. APPLY FLEXLOCK ADHESIVE ON TOP OF UPPERMOST PANEL UNITS TO FIX CAP UNITS.
5. STRUCTURAL BLOCK DOUBLE SIDED UNIT CUT / SPLITTED IN HALF MUST ALWAYS BE PRESENT AT THE CORNER OF THE WALL.

**NOTE:**

The top of Fascia Panels shall not be left exposed, they must be stabilized with a structural block on top or glued to the cap.

## GRAVITY RETAINING WALL

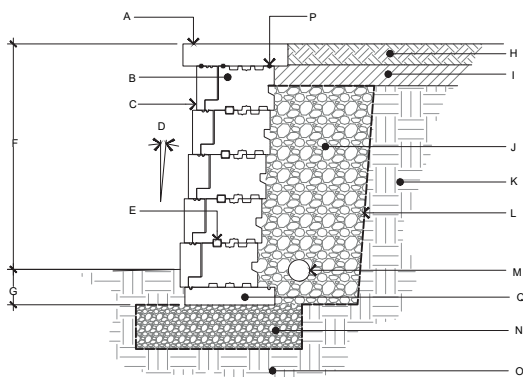

- A. TECHO-BLOC CAP UNIT SECURED TO UNIT BELOW WITH FLEXLOCK ADHESIVE
- B. STRUCTURAL BLOCK SINGLE SIDED UNIT
- C. PANEL UNIT
- D. WALL INCLINATION (5.3°)
- E. HDPE HORIZONTAL KEY
- F. EXPOSED HEIGHT
- G. EMBEDMENT DEPTH
- H. TOP SOIL
- I. LOW PERMEABILITY SOIL
- J. 3/4" (20 mm) CLEAN STONE 14" (350mm) THICK MIN.
- K. RETAINED SOIL
- L. GEOTEXTILE
- M. PERFORATED DRAIN
- N. LEVELING PAD
- O. FOUNDATION SOIL
- P. FLEXLOCK ADHESIVE
- Q. BASE UNIT

PLEASE REFER TO P.4 FOR THE CORRECT USE AND LIMITATIONS OF PROVIDED TECHNICAL INFORMATION.

# INSTALLATION GUIDE

## FREESTANDING END OF A STRAIGHT WALL (OPTION 1)

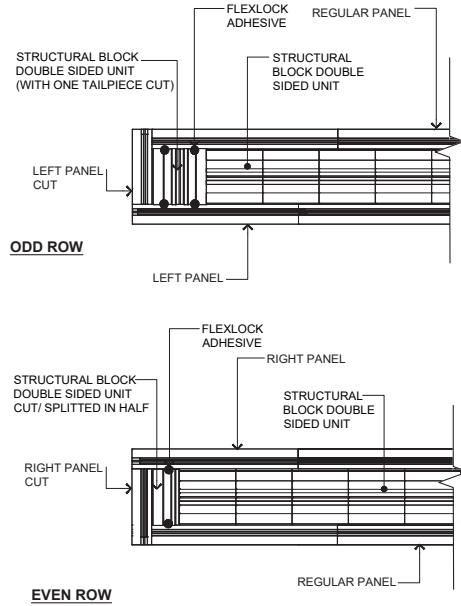

**NOTES:**

1. ALTERNATE ODD AND EVEN ROWS.
2. STAGGER STRUCTURAL BLOCKS JOINTS FROM ONE ROW TO THE NEXT.
3. GLUE ALL STRUCTURAL BLOCKS AT EACH ROW WITH FLEXLOCK ADHESIVE.
4. APPLY FLEXLOCK ADHESIVE ON TOP OF UPPERMOST PANEL UNITS TO FIX CAP UNITS.

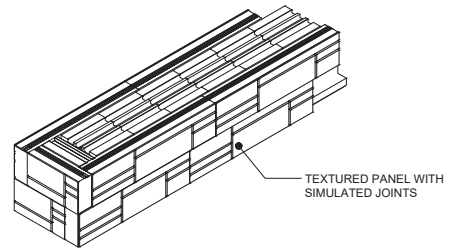

**NOTE:**

The top of Fascia Panels shall not be left exposed, they must be stabilized with a structural block on top or glued to the cap.

## FREESTANDING END OF A STRAIGHT WALL (OPTION 2)

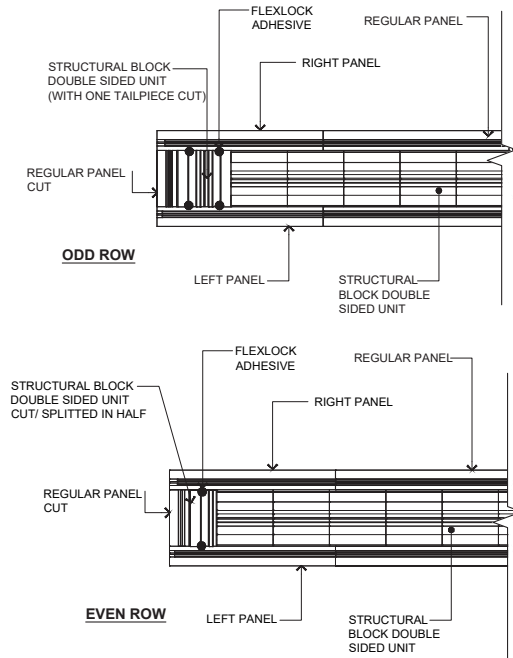

**NOTES:**

1. ALTERNATE ODD AND EVEN ROWS.
2. STAGGER STRUCTURAL BLOCKS JOINTS FROM ONE ROW TO THE NEXT.
3. GLUE ALL STRUCTURAL BLOCKS AT EACH ROW WITH FLEXLOCK ADHESIVE.
4. APPLY FLEXLOCK ADHESIVE ON TOP OF UPPERMOST PANEL UNITS TO FIX CAP UNITS.

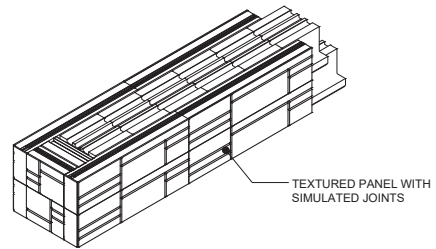

# INSTALLATION GUIDE

## PILLARS - FASCIA WALL COLLECTION

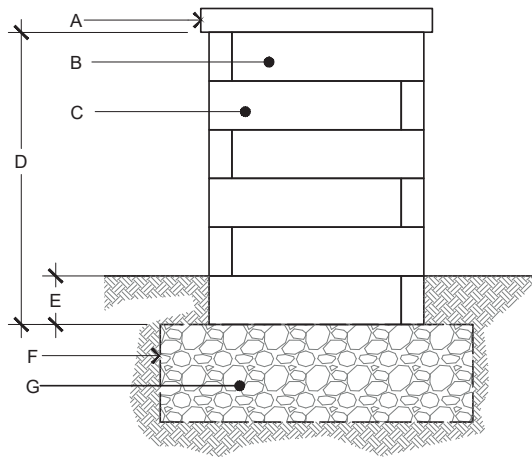

### STRUCTURAL BLOCK SINGLE SIDED UNIT CUT / SPLITTED IN HALF

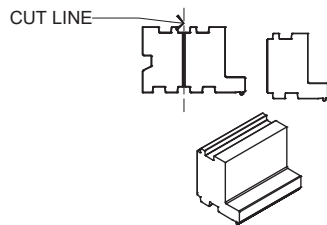

- A.** PILLAR CAP UNIT SECURED TO CORE AND PANEL BELOW WITH FLEXLOCK ADHESIVE
- B.** RIGHT PANEL
- C.** LEFT PANEL
- D.** 35 7/16" (900 mm) MAX HEIGHT
- E.** EMBEDMENT DEPTH 6" (150 mm) MIN.
- F.** GEOTEXTILE
- G.** COMPACTED GRANULAR BASE 6" (150 mm) MIN. THICKNESS ACCORDING TO PROJECT SPECIFICATIONS.

#### NOTE:

The top of Fascia Panels shall not be left exposed, they must be stabilized with a structural block on top or glued to the cap

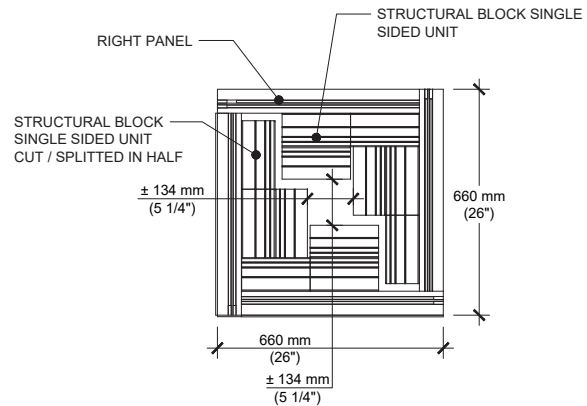

#### ODD ROW

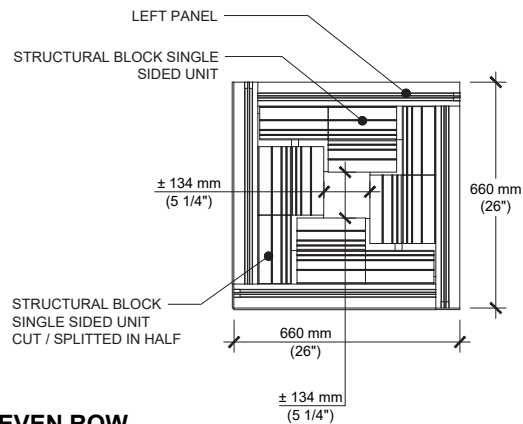

#### EVEN ROW

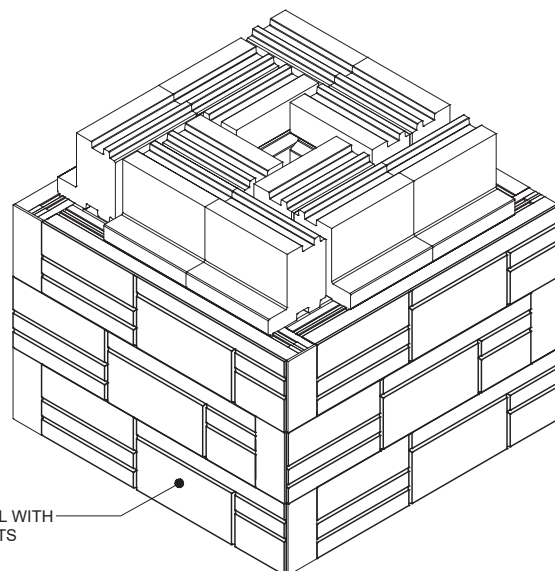

TEXTURED PANEL WITH SIMULATED JOINTS

For all possible combinations of pillars and caps, please refer to the correspondence table on page 137

# INSTALLATION GUIDE

## STEPS - FASCIA WALL COLLECTION

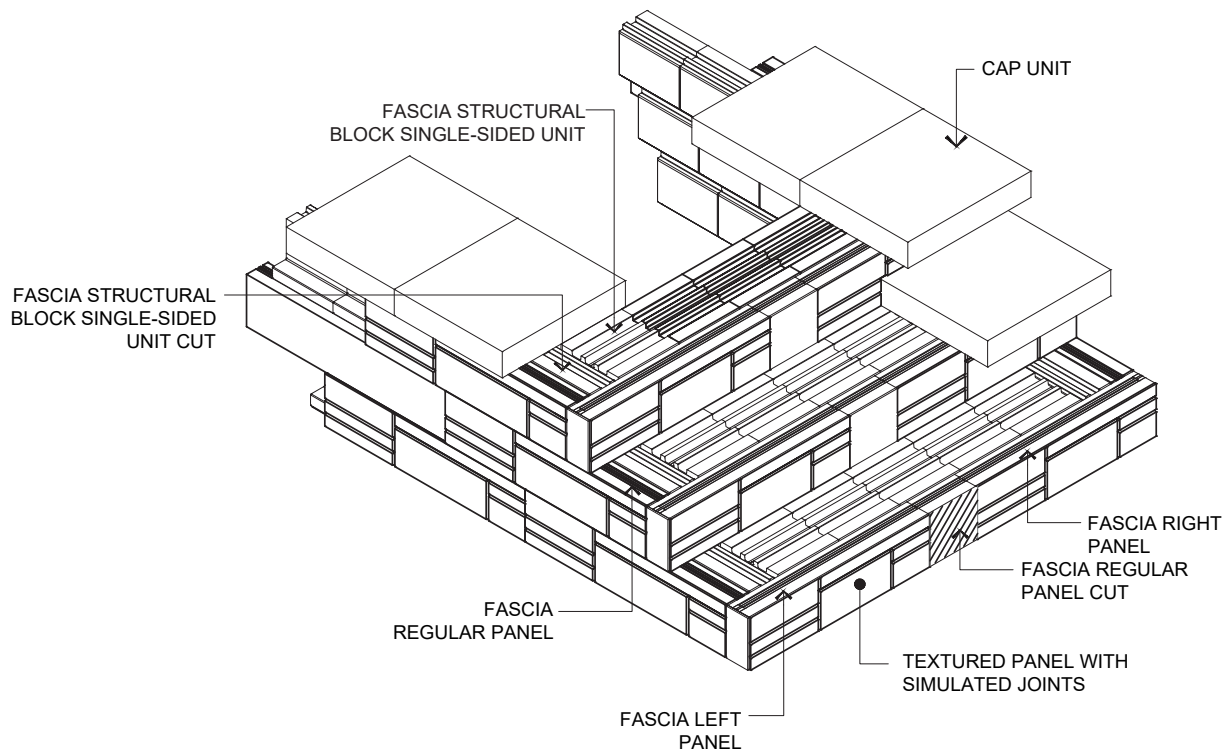
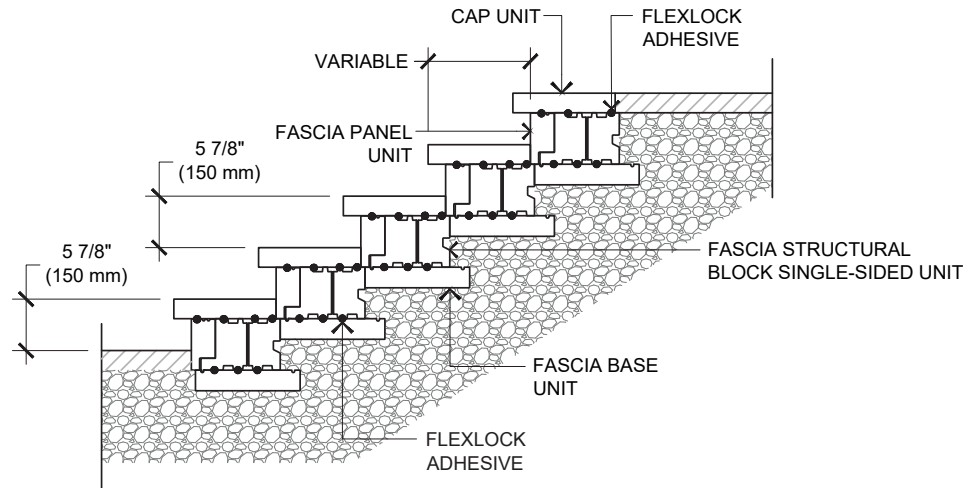

**NOTE:**

The top of Fascia Panels shall not be left exposed, they must be stabilized with a structural block on top or glued to the cap