



Mortar Net[®]
USA LTD.

HOME COMPANY INFO PRODUCTS SPECS/CADS HOW TO ORDER CONTACT US LINKS CONTINUING EDUCATION

there is
NO
"or equal"*

MORTAR NET
PRODUCT
OVERVIEW

*Mortar Net is the only device that can break up mortar on two levels. It's patented dovetail shape ensures a clear path for water to migrate out of the wall.

Source: United States Patent and Trademark Office

PRODUCT OVERVIEW

TECHNICAL DATA/SIZES

INSTALLATION

TEST RESULTS

PROJECTS

SPECS/CAD DRAWINGS

HOW TO ORDER

Mortar Net[®] is the leading mortar dropping collection product providing the solution for clogged weep holes in masonry cavity construction.

Mortar Net[®] ensures masonry walls breathe, drain and dry quickly and efficiently.

Mortar Net[®] eliminates weep hole blockage from mortar droppings and ensures water that enters the wall will be directed to the weep holes. Mortar Net[®] is placed on top of the flashing inside the wall cavity where it catches and permanently suspends mortar droppings above the level of the weep holes. Its patented dovetail shape prevents mortar from forming a continuous dam and its shape, in combination with its 90 percent open mesh weave, allows water to rapidly and easily move through the material of the product to the weeps.

It also allows for proper air movement in and out of the cavity. This eliminates pressure differentials that force moisture into the cavity, thus promoting rapid drying of the wall.

Mortar Net's[®] efficient management of moisture migration eliminates efflorescence on interior and exterior masonry walls, prevents damage caused by freeze-thaw cycles and is the first step in preventing conditions that allow mold growth.

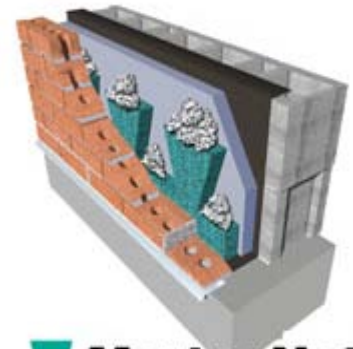

Mortar Net[®]
The Difference Is In The Cut.



Mortar Net[®]
USA LTD.

HOME COMPANY INFO PRODUCTS SPECS/CADS HOW TO ORDER CONTACT US LINKS CONTINUING EDUCATION

there is
NO
"or equal"*

MORTAR NET
TECHNICAL
DATA & SIZES

*Mortar Net is the only device that can break up mortar on two levels. It's patented dovetail shape ensures a clear path for water to migrate out of the wall.

Source: United States Patent and Trademark Office

- PRODUCT OVERVIEW
- TECHNICAL DATA/SIZES
- INSTALLATION
- TEST RESULTS
- PROJECTS
- SPECS/CAD DRAWNGS
- HOW TO ORDER

Mortar Net is made of recycled polyester or high-density polyethylene. This material will not oxidize, rot, promote mold or fungus, or react with other common building materials such as mortar, cement, asphalt, modified bitumen, PVC, copper, or galvanized metal, thereby ensuring long-term performance for all materials.

Mortar Net[®] Sizes

Width	Height	Length	Package Qty
0.4"	10"	5'	250 lf
1.0"	10"	5'	100 lf
2.0"	10"	5'	100 lf



Mortar Net[®]
The Difference Is In The Cut.



Mortar Net[®]
USA LTD.

HOME COMPANY INFO PRODUCTS SPECS/CADS HOW TO ORDER CONTACT US LINKS CONTINUING EDUCATION

there is
NO
"or equal"*

INSTALLING
MORTAR NET

*Mortar Net is the only device that can break up mortar on two levels. It's patented dovetail shape ensures a clear path for water to migrate out of the wall.

Source: United States Patent and Trademark Office

PRODUCT OVERVIEW
TECHNICAL DATA/SIZES
INSTALLATION
TEST RESULTS
PROJECTS
SPECS/CAD DRAWINGS
HOW TO ORDER

Mortar Net[®] is easy to use. It requires no fasteners or adhesives, no special skill or tools. After the first one or two courses of bricks are laid, place a continuous row of Mortar Net[®] in the cavity or collar joint on the flashing against the inside of the outer wythe at the base of the wall.

To prevent mortar bridging between the outer wythe and inner wall, install flashing and any material used as filler to match cavity width to product size extending from the bottom of Mortar Net[®] at least 6" above the top of Mortar Net.

Multiple thickness of Mortar Net[®] may be installed to match cavity widths and if excessive droppings are expected. Inspection, preparation, and installation procedure for multiple thickness is the same as for single thickness. When installing multiple thickness align the dovetail sections with each other.

Cavity should be no more than ¼" wider than 1.0" or 2.0" thick material and 0.4 thick material should touch both the outer and inner wall, insulation or filler used to adjust the cavity size. Mortar Net[®] is compressible to allow for variation in wall cavities.



Mortar Net[®]
The Difference Is In The Cut.